

RIVIAN ADVENTURE NETWORK

005 DAYTONA BEACH, FL

1100 CORNERSTONE BLVD, SUITE EV
 DAYTONA BEACH, FL 32117
DRAWING LIST

APN: 52091000050
 COORDINATES: 29.214567, -81.097352

| NO. | SHEET NAME | NO. | SHEET NAME |
|----------------|---------------------------------------|------------------|-----------------------------------|
| GENERAL | | | |
| G000 | TITLE SHEET | E000 | ELECTRICAL NOTES / LEGEND |
| G001 | GENERAL NOTES AND SPECIFICATIONS | E001 | ELECTRICAL SPECIFICATIONS |
| SURVEY | | | |
| V000 | SURVEY GENERAL NOTES | E002 | ELECTRICAL SPECIFICATIONS (CONT.) |
| V001 | SITE SURVEY | E111 | ELECTRICAL SITE PLAN |
| V002 | SITE SURVEY | E112 | PHOTOMETRIC SITE PLAN |
| V003 | SUPPLEMENTAL SURVEY | E501 | ELECTRICAL DETAILS |
| CIVIL | | | |
| C101 | CIVIL DEMOLITION PLAN | E601 | ELECTRICAL SINGLE-LINE DIAGRAM |
| C102 | CIVIL EROSION & SEDIMENT CONTROL PLAN | REFERENCE | |
| C111 | CIVIL SITE PLAN | R102 | BASIS OF DESIGN |
| C411 | CIVIL GRADING PLAN | R103 | BASIS OF DESIGN |
| C501 | CIVIL DETAILS | R201 | BASIS OF DESIGN |
| C502 | CIVIL DETAILS | R202 | BASIS OF DESIGN |
| | | R203 | BASIS OF DESIGN |

PREPARED FOR:

CLIENT
RIVIAN
 13250 HAGGERTY RD
 PLYMOUTH, MI 48170
DEPLOYMENT MANAGER CONTACT
MIKE CAMERON
 MIKECAMERON@RIVIAN.COM
 (772)485-7453
AUTHORITY HAVING JURISDICTION
DAYTONA BEACH PERMITS & LICENSING
 301 S RIDGEWOOD AVE
 DAYTONA BEACH, FL 32114
PERMIT COORDINATOR: RON ROBERTS
 ROBERTSRON@CDOB.US

REAL ESTATE MANAGER CONTACT
BEAU WHITEMAN
 BWHITEMAN@RIVIAN.COM
 (814)746-6615
UTILITY COMPANY
FLORIDA POWER & LIGHT
CONTACT: FAVYAN TORRES
 FAVYAN.TORRES@FPL.COM

PROPERTY OWNER REPRESENTATIVE
JUSTIN EDWARDS
 JUSTIN.EDWARDS@TANGEROUTLETS.COM
 (502)648-2290

PREPARED BY:

CIVIL ENGINEER
AECOM
 7650 W COURTNEY CAMPBELL CSWY
 TAMPA, FL 33607
CONTACT: KEVIN M. WESTBERRY, P.E.
 (813)675-6857

ELECTRICAL ENGINEER
AECOM
 7650 W COURTNEY CAMPBELL CSWY
 TAMPA, FL 33607
CONTACT: HENRYK B. JUSZCZYK, P.E.
 (813)636-2454

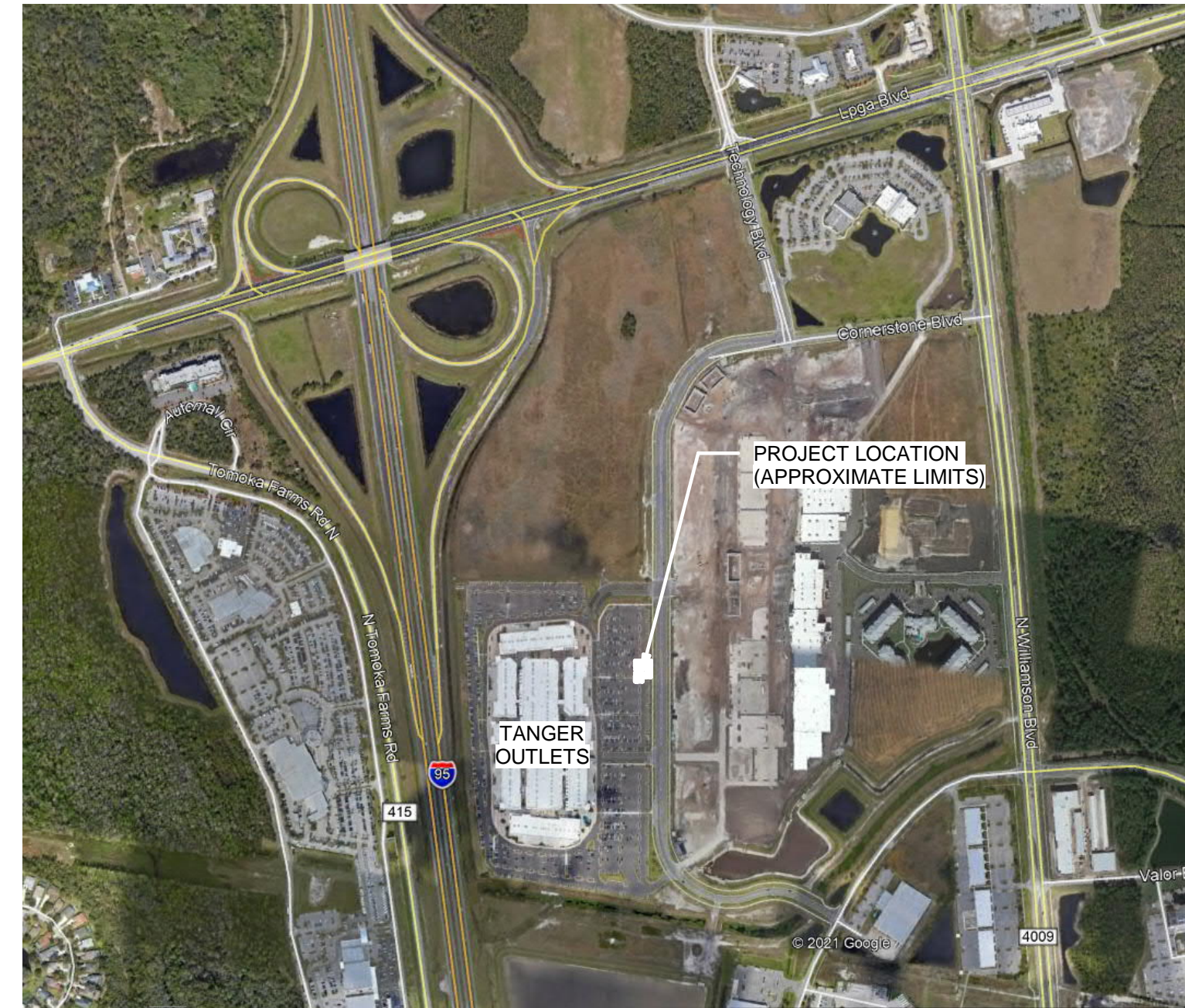

AREA VICINITY MAP

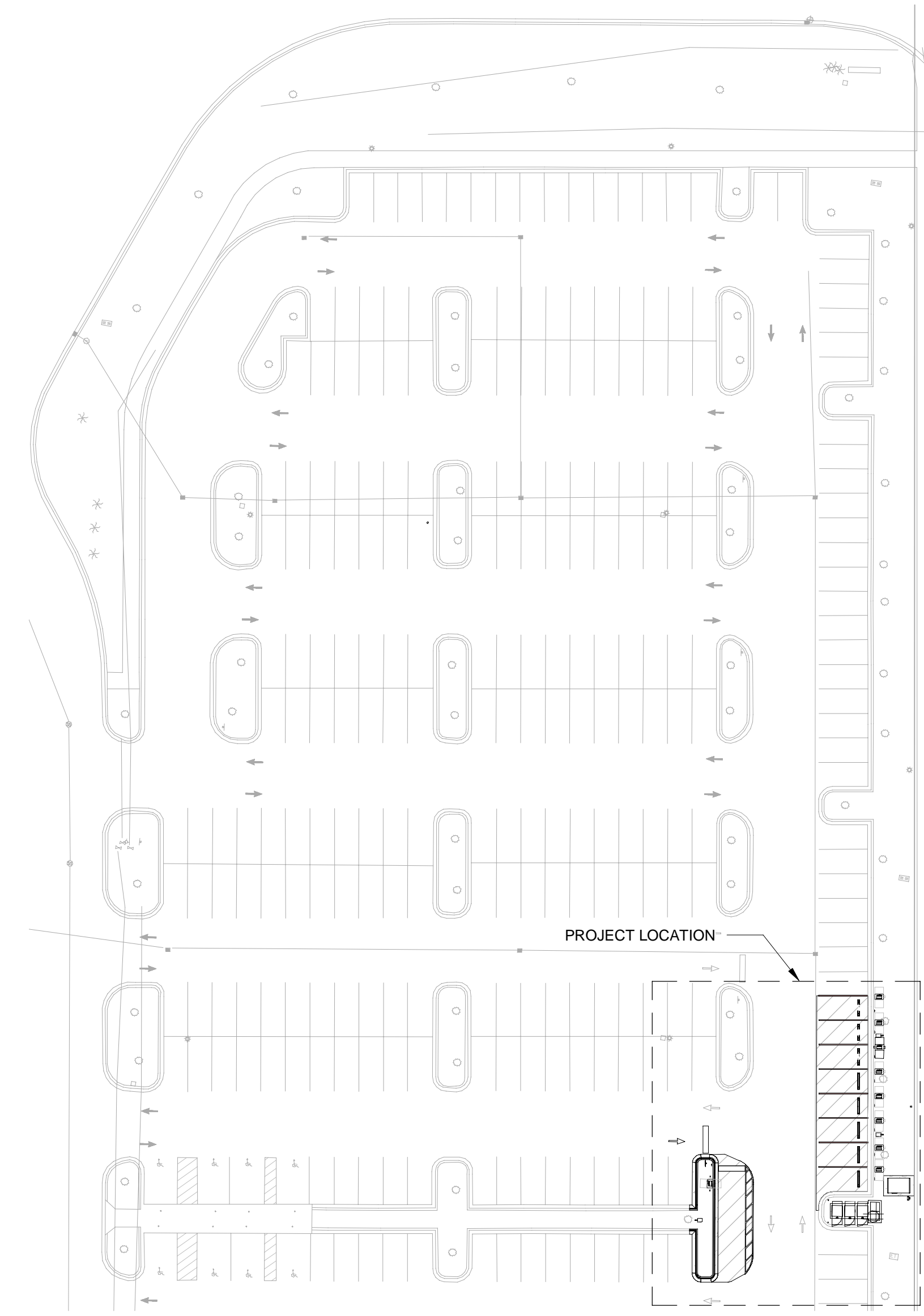

ENLARGED LOCATION MAP

| ABBREVIATIONS | | | |
|---------------|----------------------|--------|---------------------------|
| AFF | ABOVE FINISHED FLOOR | F.E.C. | FIRE EXTINGUISHER CABINET |
| B/O | BOTTOM OF | F.E. | FIRE EXTINGUISHER |
| CJ | CONTROL JOINT | FRT | FIRE RETARDANT TREATED |
| CL | CENTER LINE | F/S | FACE OF STUD |
| CLR | CLEAR | FTG | FOOTING |
| COL | COLUMN | HM | HOLLOW METAL |
| DTL | DETAIL | HP | HIGH POINT |
| DIA | DIAMETER | KD | KNOCK DOWN |
| DLO | DAYLIGHT OPENING | LF | LINEAR FOOT |
| DN | DOWN | LP | LOW POINT |
| EJ | EXPANSION JOINT | MAX | MAXIMUM |
| EL | ELEVATION | MIN | MINIMUM |
| ETR | EXISTING TO REMAIN | MO | MASONRY OPENING |
| FDN | FOUNDATION | NA | NOT APPLICABLE |
| | | NIC | NOT IN CONTRACT |
| | | NTS | NOT TO SCALE |
| | | OC | ON CENTER |
| | | OPNG | OPENING |
| | | OPP | OPPOSITE |
| | | R | RISER |
| | | RAD | RADIUS |
| | | RCP | REFLECTED CEILING PLAN |
| | | RO | ROUGH OPENING |
| | | SF | SQUARE FOOT |
| | | T/O | TOP OF |
| | | TYP | TYPICAL |
| | | UNO | UNLESS NOTED OTHERWISE |
| | | VIF | VERIFY IN FIELD |

| GRAPHIC SYMBOLS LEGEND | |
|------------------------|--|
| UNIT 1002 | ROOM NAME ROOM NUMBER |
| (A) | DOOR TYPE |
| (W) | WINDOW TYPE |
| (P) | PARTITION TYPE |
| GYP. BD. @ +8'-10" | CEILING TYPE CEILING HEIGHT |
| C A0702 | SECTION LETTER DIRECTION IN WHICH SECTION IS CUT SHEET ON WHICH SECTION IS SHOWN |
| (#) | WORK POINT, CONTROL POINT OR DATUM POINT |
| (1) A1200 | DETAIL NUMBER SHEET ON WHICH DETAIL IS SHOWN |
| (A0201) | ELEVATION NUMBER SHEET ON WHICH ELEVATION IS SHOWN |
| (#) | SHEET KEYNOTE |
| (1) | DRAWING REVISION |
| (N) | NORTH ARROW |

APPLICABLE CODE INFORMATION

NATIONAL ELECTRIC CODE 2017
 FLORIDA DEPARTMENT OF TRANSPORTATION STANDARD PLANS FOR ROAD CONSTRUCTION FY 2020-21
 FLORIDA DEPARTMENT OF ENVIRONMENTAL PROTECTION (FDEP) STANDARDS
 FLORIDA BUILDING CODE 2020

PROJECT DESCRIPTION

RIVIAN IS PROPOSING TO BUILD AN ELECTRIC VEHICLE CHARGING STATION AS A PART OF THE RIVIAN ADVENTURE NETWORK (RAN) AT THIS EXISTING SHOPPING CENTER PARKING LOT LOCATION. THIS LOCATION WILL INCLUDE SIX PROPOSED VEHICLE CHARGING DISPENSERS AND SITE WORK FOR AN ADDITIONAL THREE FUTURE VEHICLE CHARGING DISPENSERS. THIS PROJECT INCLUDES THE ASSOCIATED ELECTRICAL EQUIPMENT, POWER CABINETS, SWITCHGEAR, FOUNDATIONS, CONDUIT, PAVEMENT PREPARATION AND STRIPING, LANDSCAPING, SIGNAGE, AND SITE RESTORATION.

NOTE

CONTRACTOR SHALL FIELD-VERIFY ALL DEPTHS, LENGTHS, DIMENSIONS, ETC. IN THE FIELD AND SHALL NOT RELY ON SCALING PRINTS. DRAWING SCALES MAY NO LONGER BE ACCURATE WHEN SHEETS ARE PLOTTED TO SIZES OTHER THAN THOSE INDICATED ON THE DRAWINGS. STANDARD SIZE IS 30" X 42". REPRODUCTION MAY CAUSE DISTORTION OF DRAWINGS AND/OR SCALES.



PROJECT

RIVIAN ADVENTURE NETWORK
005 DAYTONA BEACH, FL

RIVIAN ADVENTURE NETWORK CHARGING STATION
 1100 CORNERSTONE BLVD, SUITE EV
 DAYTONA BEACH, FL 32117

CLIENT

RIVIAN
 DEPLOYMENT MANAGER MIKE CAMERON
 850 HANSEN WAY
 PALO ALTO, CA 9430
 MIKECAMERON@RIVIAN.COM
 (772)485-7453

CONSULTANT

AECOM
 150 North Orange Avenue
 Suite 200
 Orlando, FL 32801, USA
 407-843-6552 tel
 www.aecom.com

NOTE
 IT IS THE RESPONSIBILITY OF THE CONTRACTORS TO INFORM THEMSELVES OF THE EXISTING CONDITIONS AND ASSUME ALL LIABILITY FOR DAMAGE TO ALL UTILITIES, SERVICES AND STRUCTURES WHETHER ABOVE GROUND OR BELOW GROUND BEFORE COMMENCING THE WORK. SUCH INFORMATION IS NOT NECESSARILY SHOWN ON THE DRAWING, AND WHERE SHOWN, THE ACCURACY CANNOT BE GUARANTEED.

WITH THE SOLE EXCEPTION OF THE BENCHMARKS SPECIFICALLY DESCRIBED FOR THIS PROJECT, NO ELEVATION INDICATED OR ASSUMED HEREON IS TO BE USED AS A REFERENCE ELEVATION FOR ANY PURPOSE.

REGISTRATION

PROFESSIONAL OF RECORD:
 KEVIN M. WESTBERRY, P.E.
 DISCIPLINE: CIVIL
 REGISTRATION NO.: 65718

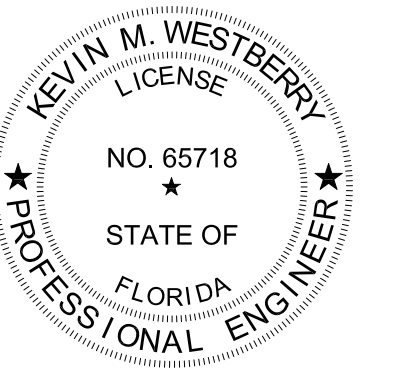

Kevin M. Westberry
 P.E. No. 65718

THIS DOCUMENT HAS BEEN DIGITALLY SIGNED AND SEALED BY KEVIN M. WESTBERRY, P.E. USING A DIGITAL SIGNATURE AND DATE. PRINTED COPIES OF THIS DOCUMENT ARE NOT CONSIDERED SIGNED AND SEALED. THE SIGNATURE MUST BE VERIFIED ON THE ELECTRONIC DOCUMENTS. THE ABOVE-NAMED PROFESSIONAL ENGINEER SHALL BE RESPONSIBLE FOR THIS SHEET IN ACCORDANCE WITH RULE 61G15-23.004, F.A.C.

ISSUE/REVISION

| NO. | DATE | DESCRIPTION |
|-----|------------|----------------------------|
| 6 | 2022-03-11 | ISSUED FOR PERMIT |
| 5 | 2022-02-18 | ISSUED FOR PERMIT |
| 4 | 2022-02-08 | PLANNING REVIEW |
| 3 | 2022-01-10 | ISSUED FOR PERMIT |
| 2 | 2021-07-26 | 90% CONSTRUCTION DOCUMENTS |
| 1 | 2021-07-14 | DRAFT FOR REVIEW |
| 0 | 2021-06-30 | 50% CONSTRUCTION DOCUMENTS |
| NO. | DATE | DESCRIPTION |

PROJECT NUMBER

60662545

SHEET TITLE

TITLE SHEET

SHEET NUMBER

G000

COORDINATE WITH AECOM ON LATEST ISSUE OF DRAWINGS BEFORE COMMENCEMENT OF CONSTRUCTION. THIS DRAWING HAS BEEN PREPARED FOR THE USE OF AECOM'S CLIENTS AND IS NOT TO BE USED FOR ANY OTHER PROJECT WITHOUT THE WRITTEN PERMISSION OF AECOM. AECOM ACCEPTS NO RESPONSIBILITY FOR THE ACCURACY OF THE INFORMATION SHOWN ON THIS SHEET. THE ELECTRONIC FILE SIGNED AND SEALED UNDER RULE 61G15-23.004, F.A.C. NOTICE: THE OFFICIAL RECORD OF THIS SHEET IS THE ELECTRONIC FILE SIGNED AND SEALED UNDER RULE 61G15-23.004, F.A.C.



Call 811 or visit sunshine811.com two full business days before digging to have buried facilities located and marked.

Check positive response codes before you dig!

PROJECT

**RIVIAN ADVENTURE NETWORK
005 DAYTONA BEACH, FL**

RIVIAN ADVENTURE NETWORK CHARGING STATION
1100 CORNERSTONE BLVD, SUITE EV
DAYTONA BEACH, FL 32117

CLIENT

RIVIAN
DEPLOYMENT MANAGER MIKE CAMERON
850 HANSEN WAY
PALO ALTO, CA 94303
MIKECAMERON@RIVIAN.COM
(772)485-7453

CONSULTANT

AECOM
150 North Orange Avenue
Suite 200
Orlando, FL 32801, USA
407-843-6552 tel
www.aecom.com

NOTE:
IT IS THE RESPONSIBILITY OF THE CONTRACTORS TO INFORM THEMSELVES OF THE EXISTING CONDITIONS AND ALL UTILITIES FOR DAMAGE TO ALL UTILITIES, SERVICES AND STRUCTURES WHETHER ABOVE GROUND OR BELOW GRADE BEFORE COMMENCING THE WORK. SUCH INFORMATION IS NOT NECESSARILY SHOWN ON THE DRAWING, AND WHERE SHOWN, THE ACCURACY CANNOT BE GUARANTEED.
WITH THE SOLE EXCEPTION OF THE BENCHMARKS SPECIFICALLY DESCRIBED FOR THIS PROJECT, NO ELEVATION INDICATED OR ASSUMED HEREON IS TO BE USED AS A REFERENCE ELEVATION FOR ANY PURPOSE.

REGISTRATION

PROFESSIONAL OF RECORD:
KEVIN M. WESTBERRY, P.E.
DISCIPLINE: CIVIL
REGISTRATION NO.: 65718

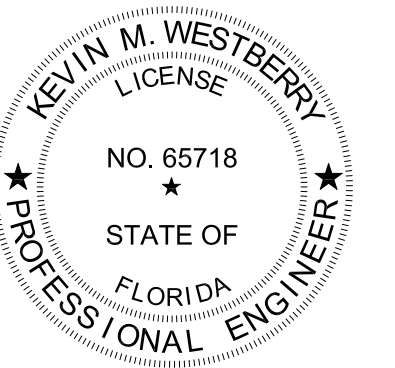

Kevin M. Westberry
P.E. No. 65718

THIS DOCUMENT HAS BEEN DIGITALLY SIGNED AND SEALED BY KEVIN WESTBERRY, P.E. USING A DIGITAL SIGNATURE AND DATE. PRINTED COPIES OF THIS DOCUMENT ARE NOT CONSIDERED SIGNED AND SEALED. THE SIGNATURE MUST BE VERIFIED ON THE ELECTRONIC DOCUMENTS. THE ABOVE-NAMED PROFESSIONAL ENGINEER SHALL BE RESPONSIBLE FOR THIS SHEET IN ACCORDANCE WITH RULE 61G15-23.004, F.A.C.

ISSUE/REVISION

| NO. | DATE | DESCRIPTION |
|-----|------------|----------------------------|
| 6 | 2022-03-11 | ISSUED FOR PERMIT |
| 5 | 2022-02-18 | ISSUED FOR PERMIT |
| 4 | 2022-02-08 | PLANNING REVIEW |
| 3 | 2022-01-10 | ISSUED FOR PERMIT |
| 2 | 2021-07-26 | 90% CONSTRUCTION DOCUMENTS |
| NO. | DATE | DESCRIPTION |

PROJECT NUMBER

60662545

SHEET TITLE

CIVIL DETAILS

SHEET NUMBER

C501

COORDINATE WITH AECOM ON LATEST ISSUE OF DRAWINGS BEFORE COMMENCEMENT OF CONSTRUCTION. THIS DRAWING HAS BEEN PREPARED FOR THE USE OF AECOM'S CLIENTS AND IS NOT TO BE REPRODUCED OR TRANSMITTED IN ANY FORM OR BY ANY MEANS, ELECTRONIC OR MECHANICAL, WITHOUT EXPRESS WRITTEN PERMISSION FROM AECOM. ALL MEASUREMENTS MUST BE OBTAINED FROM THE SHOWN DIMENSIONS.

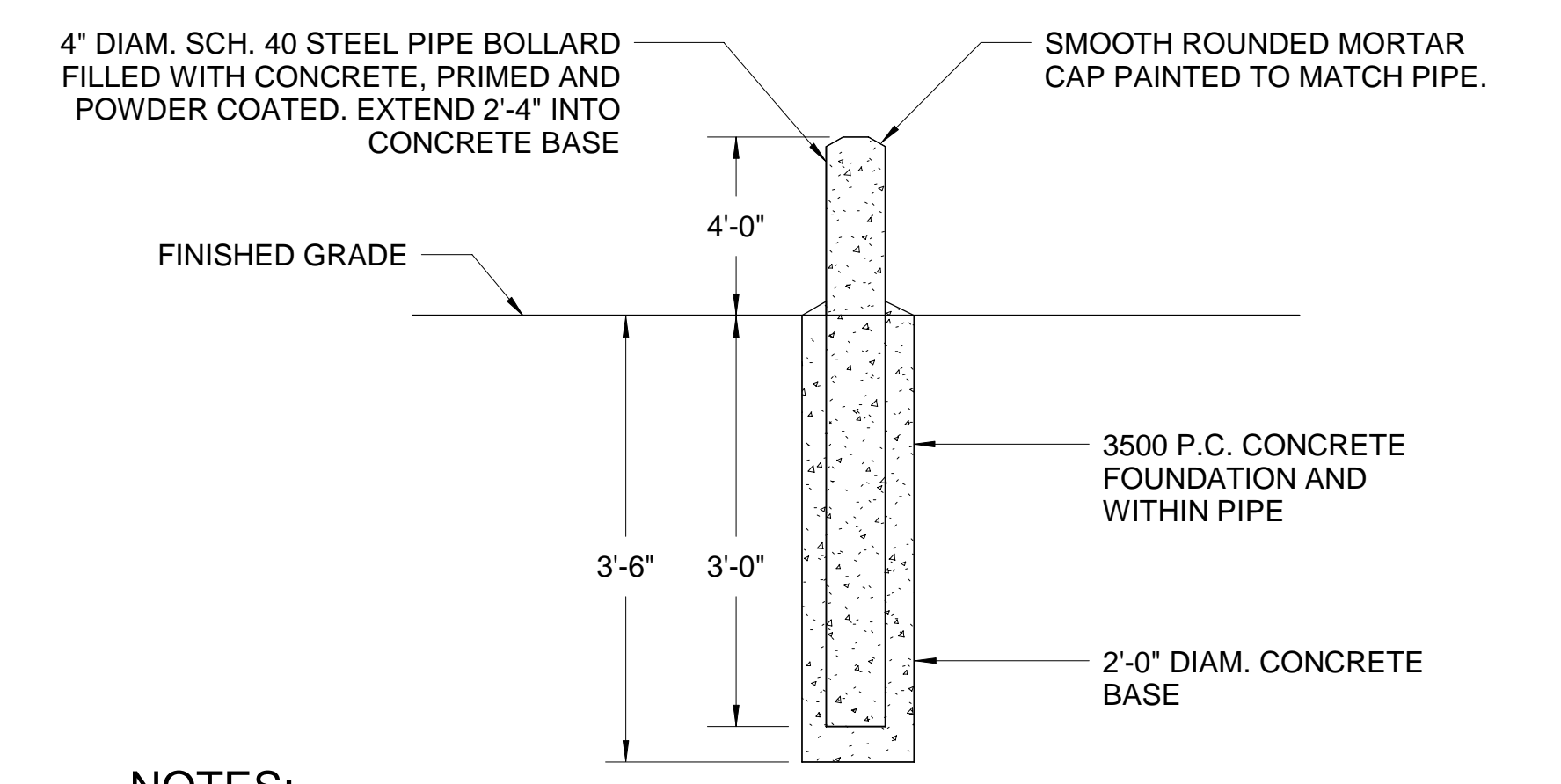
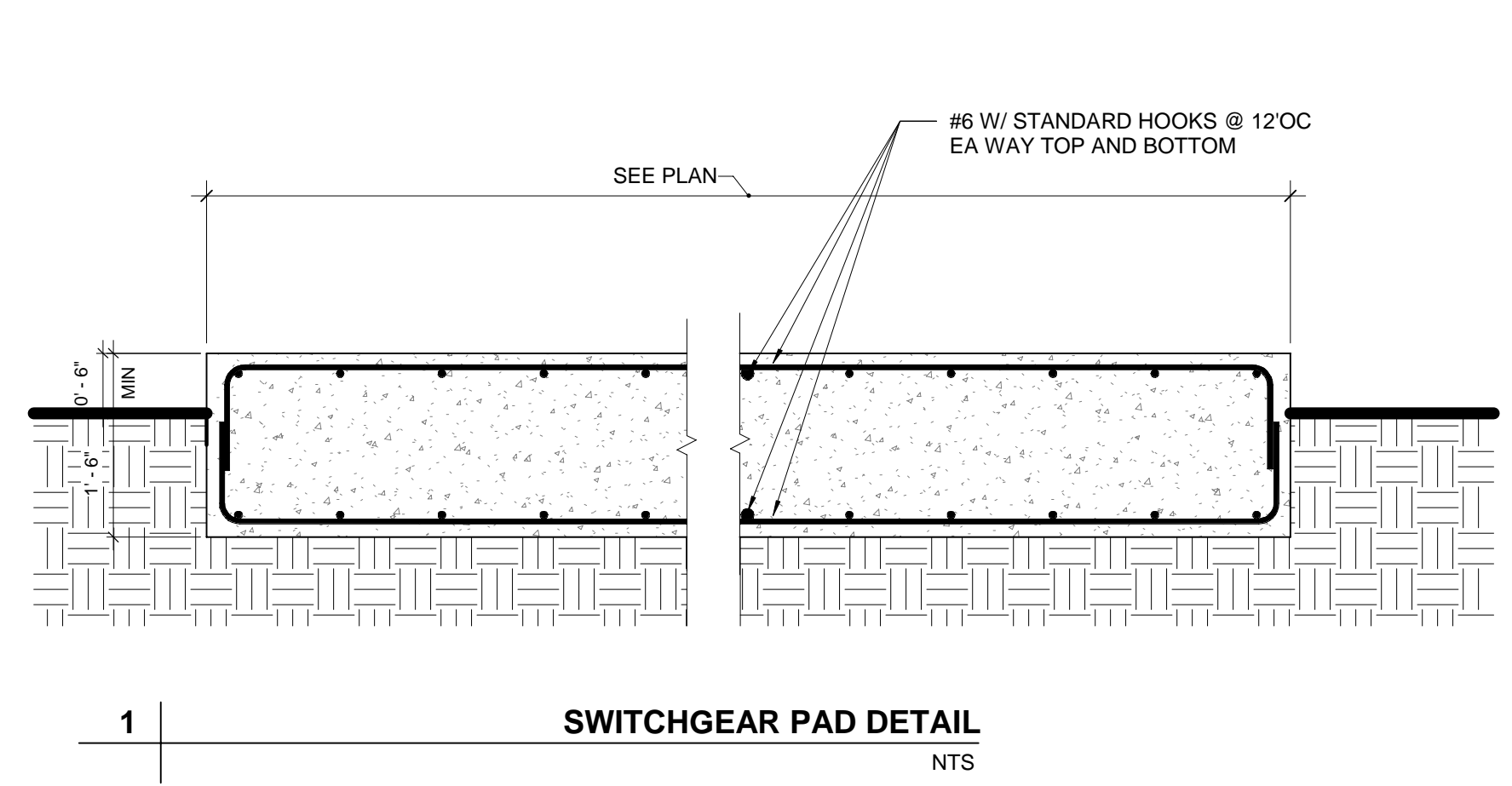

NOTES:
1. REFER TO SITE PLAN FOR BOLLARD INSTALLATION LOCATIONS, SHEET C111.

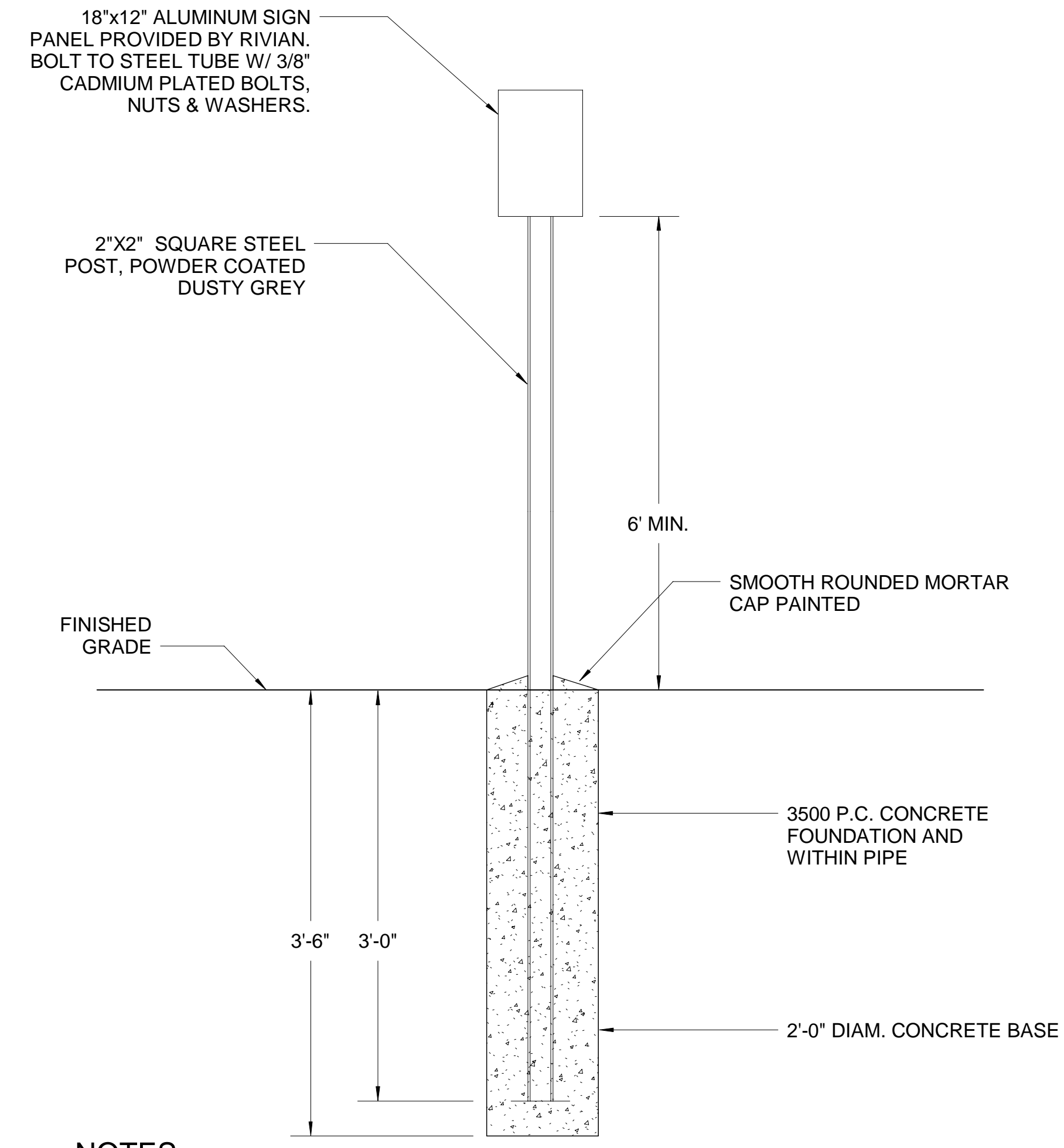

NOTES:
1. CONTRACTOR TO VERIFY AND FOLLOW LATEST EDITION OF STATE AND LOCAL SIGN DESIGN STANDARDS.
2. REFER TO SITE PLAN FOR SIGN INSTALLATION LOCATIONS, SHEET C111.
3. ALL SIGNS SHALL COMPLY WITH THE U.S. DEPARTMENT OF TRANSPORTATION, FEDERAL HIGHWAY ADMINISTRATION'S "MANUAL OF UNIFORM TRAFFIC CONTROL DEVICES", LOCAL CODES, AND AS SPECIFIED. MOUNT SIGNS TO POST IN ACCORDANCE WITH MANUFACTURERS INSTRUCTIONS.

VEHICLE CHARGING WITH SIGNS



CONCEPT ART FOR SIGN, SEE NOTE 3.
BACKGROUND: RAL 6012 (GREEN/BLACK)
BACK SIDE: FACTORY WHITE BACKING
LETTERING: 3M REFLECTIVE 7MIL VINYL (IJ5100R) (WHITE)

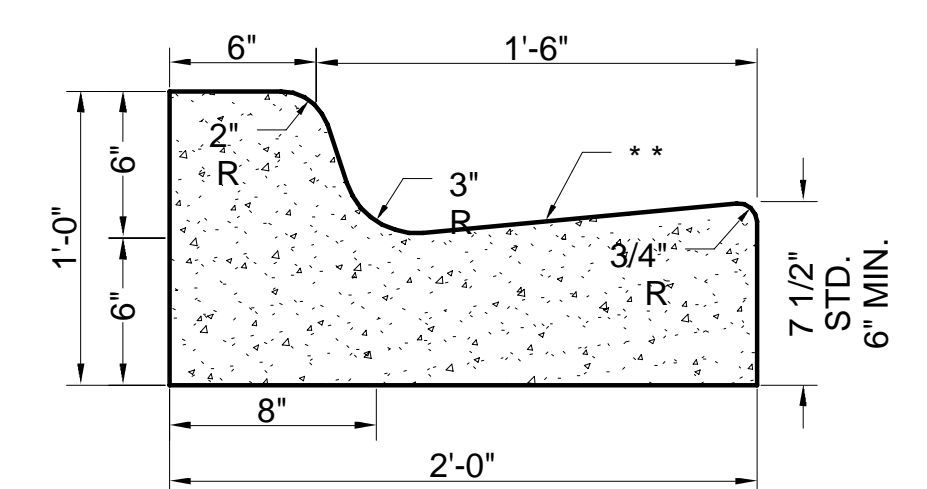

NOTES:
** WHEN USED ON THE HIGH SIDE OF ROADWAYS, THE CROSS SLOPE OF THE GUTTER SHALL MATCH THE CROSS SLOPE OF THE ADJACENT PAVEMENT (GUTTER SHALL DRAIN AWAY FROM THE CURB). THE THICKNESS OF THE LIP SHALL BE 6", UNLESS OTHERWISE SHOWN ON PLANS.
1. FOR USE ADJACENT TO CONCRETE OR FLEXIBLE PAVEMENT. EXPANSION JOINT, PREFORMED JOINT FILLER AND JOINT SEAL ARE REQUIRED BETWEEN CURBS AND CONCRETE PAVEMENT ONLY.
2. FOR CURB AND CURB AND GUTTER PROVIDE 1/8" - 1/4" CONTRACTION JOINTS AT 10' CENTERS (MAX.). CONTRACTION JOINTS ADJACENT TO CONCRETE PAVEMENT ON TANGENTS AND FLAT CURVES ARE TO MATCH THE PAVEMENT JOINTS, WITH INTERMEDIATE JOINTS NOT TO EXCEED 10' CENTERS. CURB, GUTTER AND CURB & GUTTER EXPANSION JOINTS SHALL BE LOCATED IN ACCORDANCE WITH SECTION 520 OF THE STANDARD FDOT SPECIFICATIONS.
3. ENDS OF CURBS SHALL TRANSITION FROM FULL TO ZERO HEIGHTS IN 3 FEET.
4. SEE FDOT STANDARD PLANS INDEX 520-001 AND SPECIFICATION 520 FOR ADDITIONAL INFORMATION.

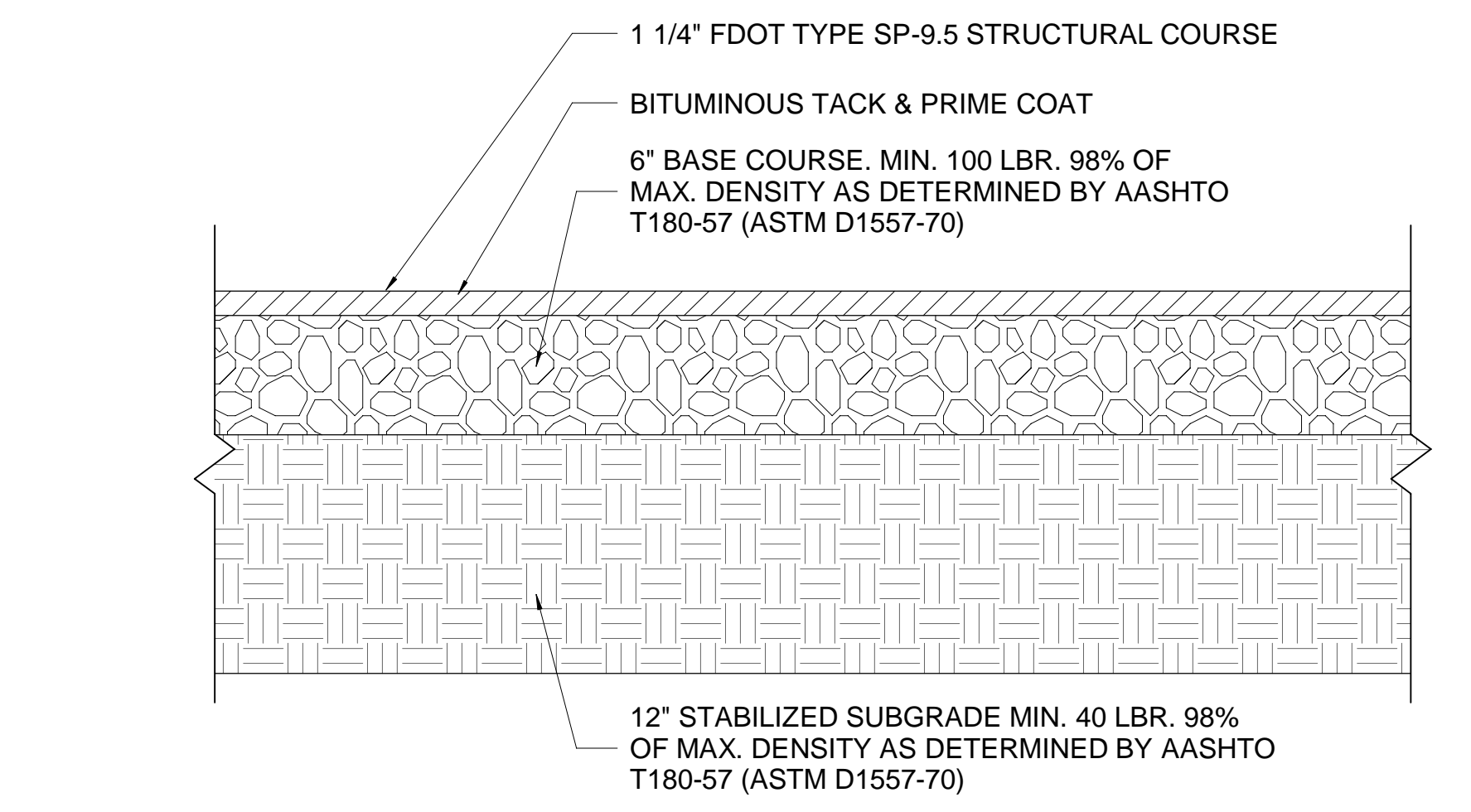

5 TYPICAL STANDARD DUTY ASPHALT PAVEMENT SECTION NTS

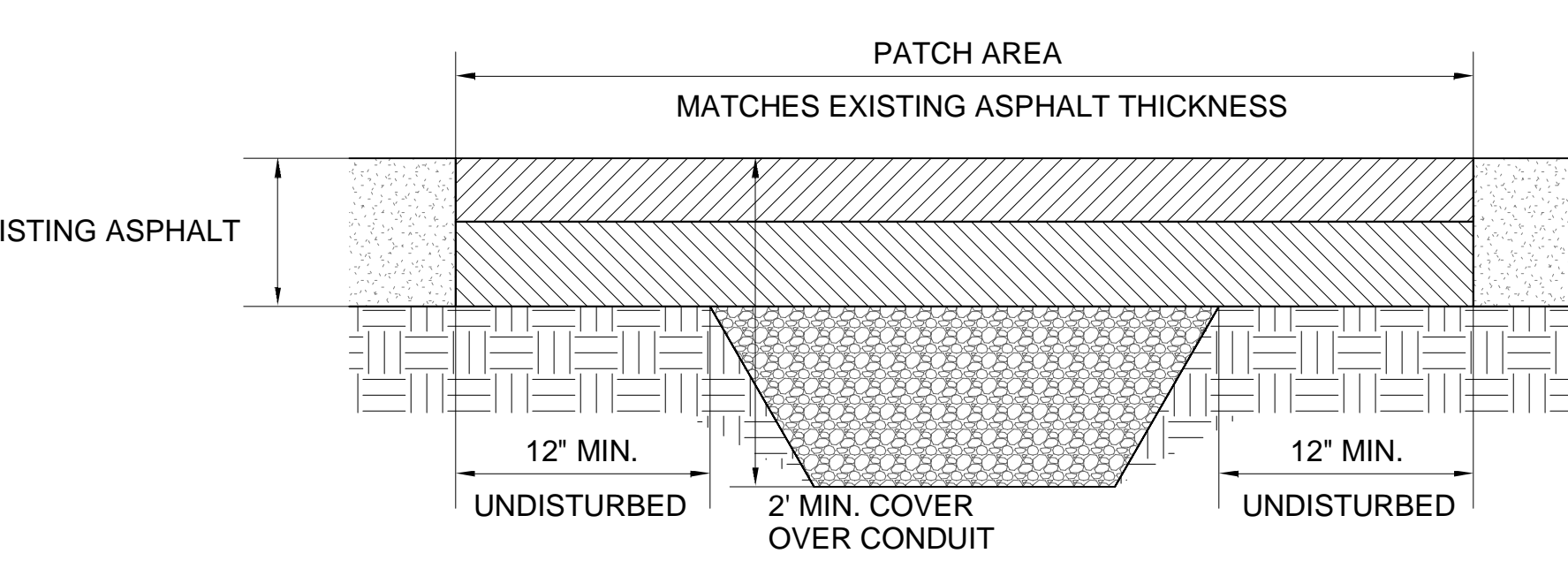

7 ASPHALT PATCH DETAIL NTS

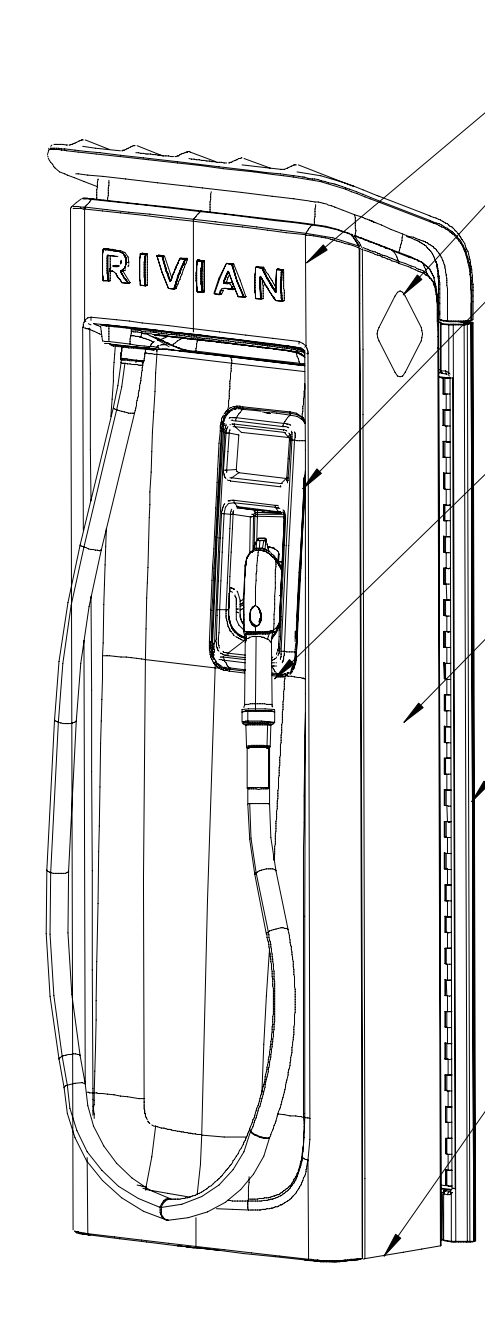
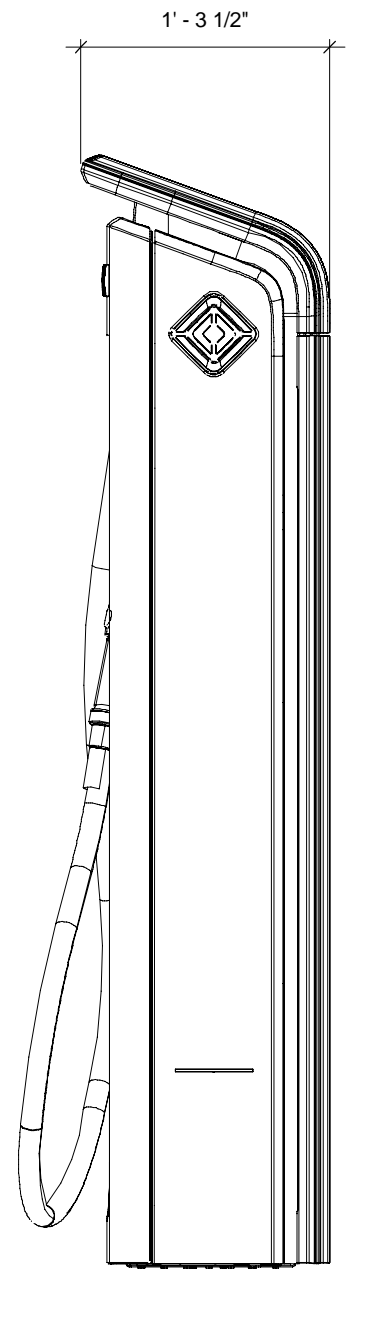
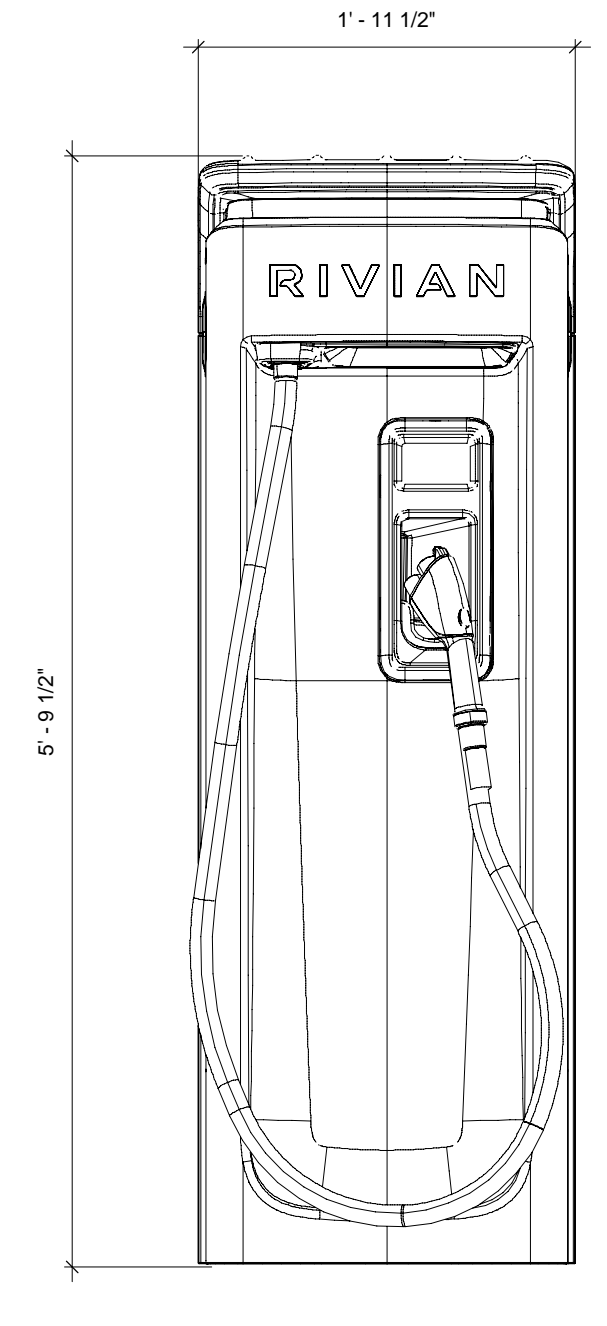
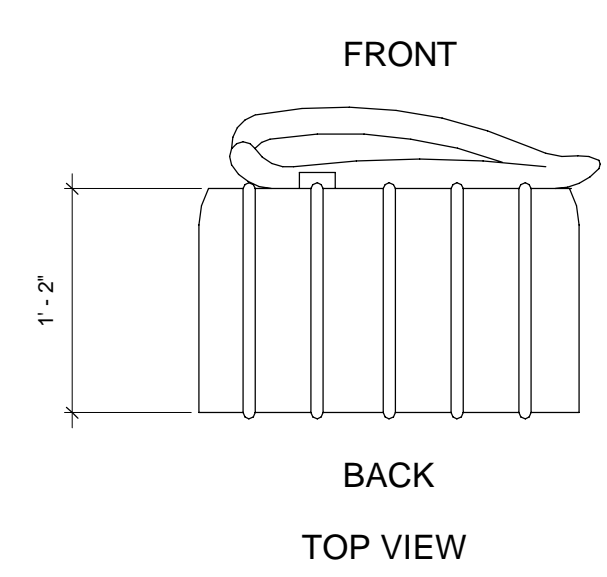

6 DCFC DISPENSER PROVIDED BY RIVIAN NTS

FRONT PANEL AND DOOR INJECTION MOLDED PLASTIC WITH JVIS PAINT 'RIVIAN WHITE' (TRAFFIC WHITE RAL# 9016)
RIVIAN BRANDING INJECTION MOLDED PLASTIC WITH JVIS PAINT 'RIVIAN YELLOW' (SIGNAL YELLOW RAL# 1003)
MOBILE APP PROVIDES PROPERTY LOCATION AND GPS NAVIGATION TO CHARGER, CHARGER STATUS, AND NOTIFICATIONS. ALL PAYMENTS THROUGH THE APP. NO ONBOARD PAYMENT / CREDIT CARD READER.
STANDARD CCS CONNECTOR CHARGERS CAPABLE OF 300KW AND OUTPUT VOLTAGES UP TO 1,000V
SIDE PANEL INJECTION MOLDED PLASTIC WITH JVIS PAINT 'RIVIAN BLACK' (SIGNAL BLACK RAL# 9004)
SECURE DOOR FOR MAINTENANCE ACCESS
BOLTED TO CONCRETE FOUNDATION

