

RIVIAN

APPLICANT SITE NAME:
MARYSVILLE, WA

SSC SITE NUMBER:
RIVN-RAN-WA-0004

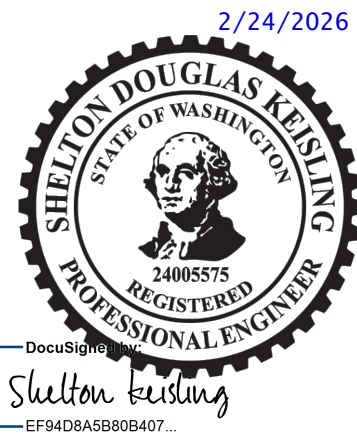

DocuSign
Shelton Keisling
EF94D8A5B80B407...

PROJECT:
RIVIAN ADVENTURE
NETWORK

DRAWING DESCRIPTION:
FINAL CD100

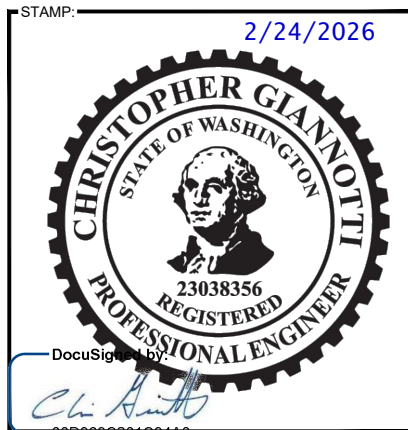

DocuSign
Ch. Giannotti

ENGINEERING LICENSE			
STATE OF WASHINGTON			
STATE CERTIFICATE OF AUTHORIZATION # 602220502			
ENGINEER:	PE#:	DISCIPLINE:	
CG CHRISTOPHER GIANNOTTI	23038356	CIVIL C	
PMS PHILIP M. SWOBODA	25027516	CIVIL	
SDK SHELTON D. KEISLING	24005575	ELECTRICAL E	
TMS TERRANCE M. SUPER	39005	ELECTRICAL	

AERIAL MAP

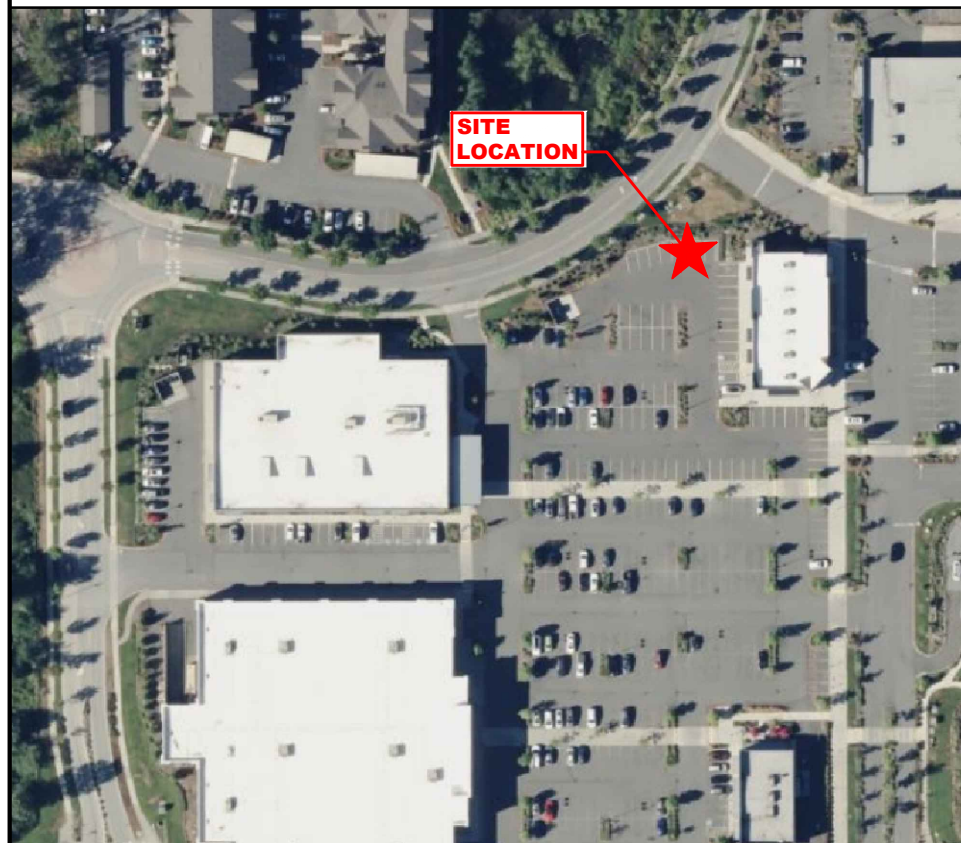

SITE INFORMATION

SITE LOCATION:	LATITUDE: 48.153249° N (NAD 83) LONGITUDE: 122.197829° W (NAD 83) GROUND ELEV: 124' AMSL	APPLICANT:	RIVIAN
SITE ADDRESS:	2437 172ND ST NE, SUITE EV MARYSVILLE, WA 98271	RIVIAN REAL ESTATE MANAGER:	CONTACT: ZAC WHITNEY EMAIL: zacwhitney@rivian.com PHONE: (520) 668-5596
COUNTY:	SNOHOMISH	RIVIAN DEPLOYMENT MANAGER:	CONTACT: KEN TAKADA EMAIL: kentakada@rivian.com PHONE: (805) 234-6610
JURISDICTION:	CITY OF MARYSVILLE, WA CONTACT: AMY HESS EMAIL: ahess@marysvillewa.gov PHONE: (360) 363-8215	PROPERTY OWNER:	SMOKEY POINT COMMERCIAL II LLC CONTACT: TBD EMAIL: TBD PHONE: TBD
ASSIGNED PARCEL #:	31052000305500	UTILITY COMPANY:	SNOHOMISH COUNTY PUD CONTACT: DAVE WOOD EMAIL: dbwood@snopud.com PHONE: (425) 308-1674

DRAWING INDEX

SHEET NO.	SHEET DESCRIPTION	DISC.
T-1.0	TITLE SHEET	C/E
	SURVEY (BY OTHERS)	
C-1.0	OVERALL SITE PLAN	C
C-1.1	EXISTING SITE PLAN	C
C-1.2	ENLARGED SITE PLAN	C
C-1.3	SITE ELEVATION	C
C-2.0	EQUIPMENT PLANS	C
C-3.0	EQUIPMENT DETAILS (1 OF 5)	C
C-3.1	EQUIPMENT DETAILS (2 OF 5)	C
C-3.2	EQUIPMENT DETAILS (3 OF 5)	C
C-3.3	EQUIPMENT DETAILS (4 OF 5)	C
C-3.4	EQUIPMENT DETAILS (5 OF 5)	C
E-1.0	UTILITY PLAN	E
E-1.1	RIVIAN UTILITY PLAN	E
E-2.0	RIVIAN RISER DIAGRAM	E
E-2.1	ELECTRICAL ONE-LINE DIAGRAM	E
E-2.2	PANEL SCHEDULE	E
E-3.0	ELECTRICAL DETAILS (1 OF 2)	E
E-3.1	ELECTRICAL DETAILS (2 OF 2)	E
G-1.0	GROUNDING RISER DIAGRAM	E
G-2.0	GROUNDING DETAILS	E
SP-1.0	SPECIFICATIONS (1 OF 5)	C
SP-1.1	SPECIFICATIONS (2 OF 5)	C
SP-1.2	SPECIFICATIONS (3 OF 5)	C
SP-2.0	SPECIFICATIONS (4 OF 5)	E
SP-2.1	SPECIFICATIONS (5 OF 5)	E

PLANS PREPARED FOR:



PLANS PREPARED BY:



DRAWING NOTICE:
THIS DRAWING HAS NOT BEEN PUBLISHED AND IS THE SOLE PROPERTY OF SSC, INC. AND IS LENT TO THE BORROWER FOR THEIR CONFIDENTIAL USE ONLY, AND IN CONSIDERATION OF THE LOAN OF THIS DRAWING, THE BORROWER PROMISES AND AGREES TO RETURN IT UPON REQUEST AND AGREES THAT IT WILL NOT BE REPRODUCED, COPIED, LENT OR OTHERWISE DISPOSED OF DIRECTLY OR INDIRECTLY, NOR USED FOR ANY PURPOSE OTHER THAN FOR WHICH IT IS FURNISHED.

DESCRIPTION	DATE	BY	REV
ISSUED FOR PERMITTING	02/24/26	ITM	0

APPLICANT SITE NAME:

MARYSVILLE, WA

SSC SITE NUMBER:

RIVN-RAN-WA-0004

SITE ADDRESS:

2437 172ND ST NE, STE. EV
MARYSVILLE, WA 98271

SHEET DESCRIPTION:

TITLE SHEET

SHEET #:

T-1.0

JURISDICTION COMPLIANCE

ALL WORK SHALL BE PERFORMED AND MATERIALS INSTALLED IN ACCORDANCE WITH THE CURRENT EDITIONS OF THE FOLLOWING CODES AS ADOPTED BY THE LOCAL GOVERNING AUTHORITIES. NOTHING IN THESE PLANS IS TO BE CONSTRUED TO PERMIT WORK NOT CONFORMING TO THESE CODES.

- 2021 INTERNATIONAL BUILDING CODE
- 2021 INTERNATIONAL MECHANICAL CODE
- ASCE 7-16 STRUCTURAL STANDARD
- NFPA 780 - LIGHTNING PROTECTION CODE
- 2023 NATIONAL ELECTRICAL CODE



Know what's below.
Call before you dig.
www.call811.com

THE UTILITIES AS SHOWN ON THIS SET OF DRAWINGS WERE DEVELOPED FROM THE INFORMATION AVAILABLE. THE INFORMATION PROVIDED IS NOT IMPLIED NOR INTENDED TO BE THE COMPLETE INVENTORY OF UTILITIES IN THIS AREA. IT IS THE CONTRACTOR'S RESPONSIBILITY TO VERIFY THE LOCATION OF ALL UTILITIES (WHETHER SHOWN OR NOT) AND PROTECT SAID UTILITIES FROM ANY DAMAGE CAUSED BY CONTRACTOR'S ACTIVITIES.

SITE LOCATION QR CODE



CONSULTING TEAM

ENGINEERING:
SSC, INC.
7171 WEST 95TH STREET, SUITE 600
OVERLAND PARK, KANSAS 66212
PHONE: (913) 438-7700
FAX: (913) 438-7777

CLIENT MANAGER:
ANTHONY WHYTE

A&E PROJECT MANAGER:
ANTHONY WHYTE

LEAD ENGINEER:
CHRISTOPHER GIANNOTTI

LEAD ELECTRICAL:
SHELTON KEISLING

LINETYPE LEGEND:

	EXISTING R.O.W.
	EXISTING OVERHEAD POWER
	EXISTING UNDERGROUND COMMERCIAL/RESIDENTIAL POWER
	EXISTING UNDERGROUND TELCO/FIBER
	EXISTING UNDERGROUND NATURAL GAS
	EXISTING UNDERGROUND WATER LINE
	EXISTING UNDERGROUND SEWER LINE
	EXISTING UNDERGROUND STORM WATER LINE

GENERAL NOTES:

1. EXISTING PROPERTY LINES, RIGHT-OF-WAY BOUNDARIES, EASEMENT BOUNDARIES, SETBACKS, AND UTILITIES ARE SHOWN FOR REFERENCE ONLY.

PARKING STALL SCHEDULE

DESCRIPTION	COUNT
TOTAL # OF STALLS REQUIRED	8
TOTAL # OF INITIAL CHARGING STALLS	8
NET STALL COUNT	0

STAMP: 2/24/2026

DocuSign
Ch. Giannotti

ENGINEERING LICENSE
STATE OF WASHINGTON
STATE CERTIFICATE OF AUTHORIZATION # 602220502

ENGINEER:	PE#:	DISCIPLINE:
CG CHRISTOPHER GIANNOTTI	23038356	CIVIL
PMS PHILIP M. SWOBODA	25027516	CIVIL
SDK SHELTON D. KEISLING	24005575	ELECTRICAL
TMS TERRANCE M. SUPER	39005	ELECTRICAL

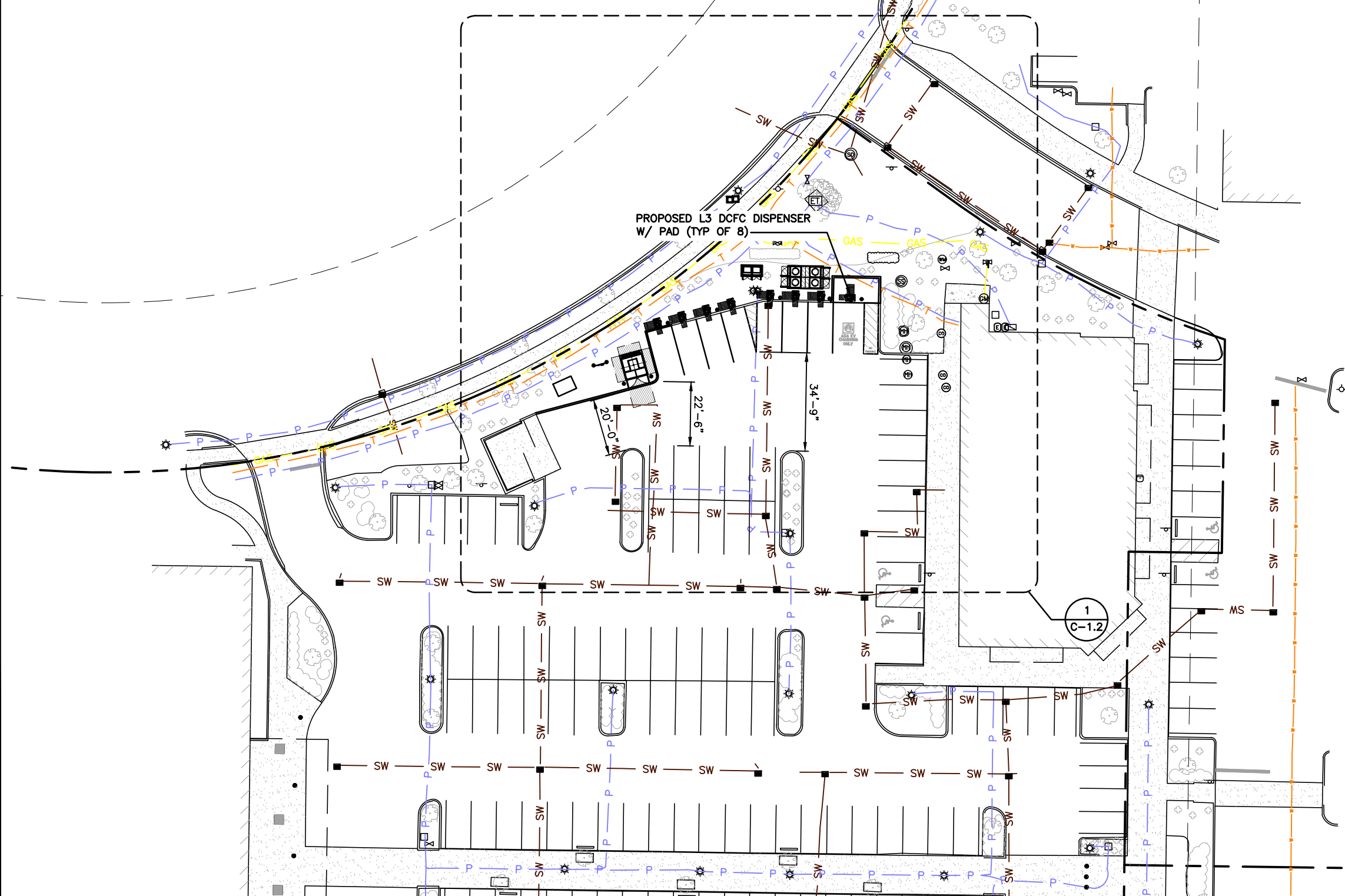

AERIAL SITE PLAN

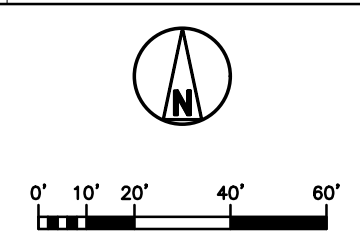

SCALE 1:20 (22x34)
SCALE 1:40 (11x17)

PLANS PREPARED FOR:



PLANS PREPARED BY:



DRAWING NOTICE:
THIS DRAWING HAS NOT BEEN PUBLISHED AND IS THE SOLE PROPERTY OF SSC, INC. AND IS LENT TO THE BORROWER FOR THEIR CONFIDENTIAL USE ONLY, AND IN CONSIDERATION OF THE LOAN OF THIS DRAWING, THE BORROWER PROMISES AND AGREES TO RETURN IT UPON REQUEST AND AGREES THAT IT WILL NOT BE REPRODUCED, COPIED, LENT OR OTHERWISE DISPOSED OF DIRECTLY OR INDIRECTLY, NOR USED FOR ANY PURPOSE OTHER THAN FOR WHICH IT IS FURNISHED.

SUBMITTALS:

DESCRIPTION	DATE	BY	REV
ISSUED FOR PERMITTING	02/24/26	ITM	0

APPLICANT SITE NAME:

MARYSVILLE, WA

SSC SITE NUMBER:

RIVN-RAN-WA-0004

SITE ADDRESS:

2437 172ND ST NE, STE. EV
MARYSVILLE, WA 98271

SHEET DESCRIPTION:

AERIAL SITE PLAN

SHEET #:

C-1.0

PARKING STALL LEGEND	
DESCRIPTION	SYMBOL
PROPOSED DCFC DISPENSER	#

SIGNAGE SCHEDULE			
POWER CABINET	DISPENSER	ENABLED/DEDICATED:	IDENTIFICATION:
PC-1	1A	DEDICATED	CH-302
	1B	DEDICATED	CH-302
PC-2	2A	DEDICATED	CH-302
	2B	DEDICATED	CH-302
PC-3	3A	DEDICATED	CH-302
	3B	DEDICATED	CH-302
PC-4	4A	DEDICATED	CH-302
	4B	DEDICATED	CH-302

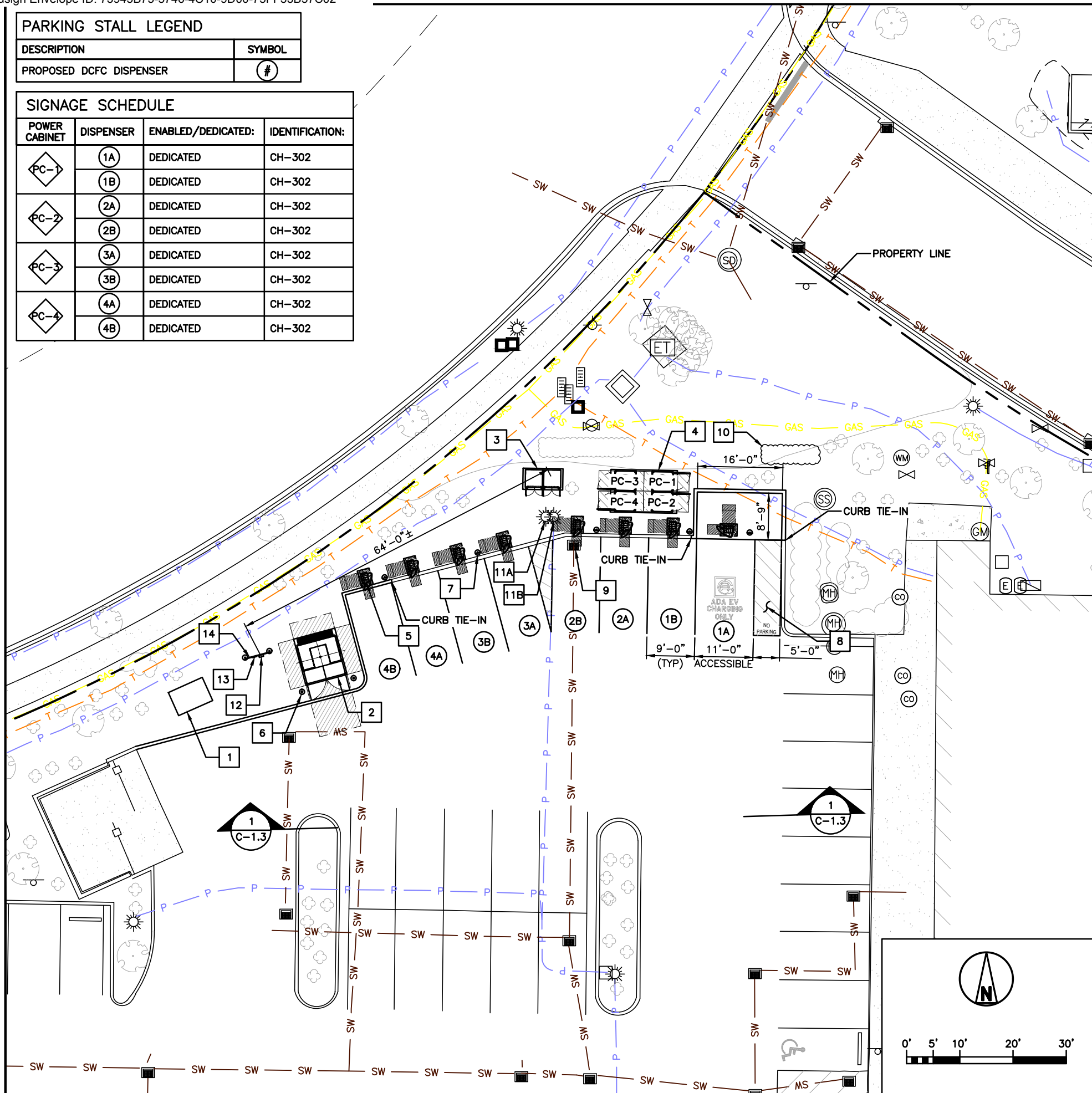

ENLARGED SITE PLAN

SCALE 1:10 (22x34)
SCALE 1:20 (11x17)

GENERAL NOTES:

- RIVIAN CONTRACTOR TO REFERENCE DETAILS OF SNOHOMISH COUNTY PUD UTILITY DESIGN AND SPECIFICATIONS.
- PROPOSED CURB TO MATCH EXISTING. CONTRACTOR SHALL INSTALL PER LOCAL JURISDICTIONAL STANDARDS AND REQUIREMENTS.
- ADA STALL SIGN POST TO READ ACCESSIBLE PRIORITY.
- CONTRACTOR TO USE EXTREME CAUTION WHEN WORKING NEAR STORM DRAIN.

KEYED NOTES:

- PROPOSED JUNCTION BOX
- PROPOSED TRANSFORMER (TBD BY UTILITY COMPANY)
- PROPOSED SWITCHBOARD W/ EQUIPMENT PAD
- PROPOSED PAD MOUNTED POWER CABINET (TYP OF 4)
- PROPOSED L3 DCFC DISPENSER (TYP OF 8)
- PROPOSED UTILITY BOLLARD (TYP OF 2)
- PROPOSED SIGN POST (TYP OF 4) (SEE SHEET 3.2, DETAIL 6)
- PROPOSED ADA COMPLIANT STRIPING
- EXISTING STORM DRAIN (SEE GENERAL NOTE)
- PROPOSED/RELOCATED LANDSCAPING (MATCH EXISTING)
- RELOCATED LIGHT POLE
- EXISTING LIGHT POLE TO BE RELOCATED
- PROPOSED EPO SWITCH (PER MANUFACTURER'S SPECIFICATIONS)
- PROPOSED EPO SIGN (SEE SHEET C-3.4, DETAIL 1)
- PROPOSED UTILITY RACK (SEE SHEET C-3.4, DETAIL 2)

STAMP: 2/24/2026

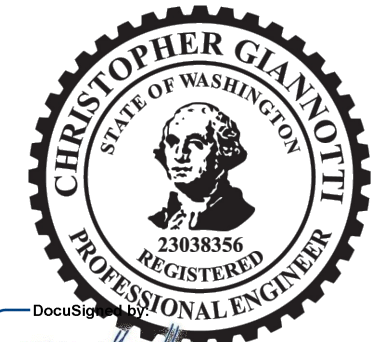

ENGINEERING LICENSE		
STATE OF WASHINGTON		
STATE CERTIFICATE OF AUTHORIZATION # 602220502		
ENGINEER:	PE#:	DISCIPLINE:
CG CHRISTOPHER GIANNOTTI 23038356		CIVIL CC
PMS PHILIP M. SWOBODA 25027516		CIVIL
SDK SHELTON D. KEISLING 24005575		ELECTRICAL
TMS TERRANCE M. SUPER 39005		ELECTRICAL

PLANS PREPARED FOR:



PLANS PREPARED BY:



DRAWING NOTICE:
THIS DRAWING HAS NOT BEEN PUBLISHED AND IS THE SOLE PROPERTY OF SSC, INC. AND IS LENT TO THE BORROWER FOR THEIR CONFIDENTIAL USE ONLY, AND IN CONSIDERATION OF THE LOAN OF THIS DRAWING, THE BORROWER PROMISES AND AGREES TO RETURN IT UPON REQUEST AND AGREES THAT IT WILL NOT BE REPRODUCED, COPIED, LENT OR OTHERWISE DISPOSED OF DIRECTLY OR INDIRECTLY, NOR USED FOR ANY PURPOSE OTHER THAN FOR WHICH IT IS FURNISHED.

SUBMITTALS:	DESCRIPTION	DATE	BY	REV
ISSUED FOR PERMITTING		02/24/26	ITM	0

APPLICANT SITE NAME:

MARYSVILLE, WA

SSC SITE NUMBER:

RIVN-RAN-WA-0004

SITE ADDRESS:

2437 172ND ST NE, STE. EV
MARYSVILLE, WA 98271

SHEET DESCRIPTION:

ENLARGED SITE PLAN

SHEET #:

C-1.2

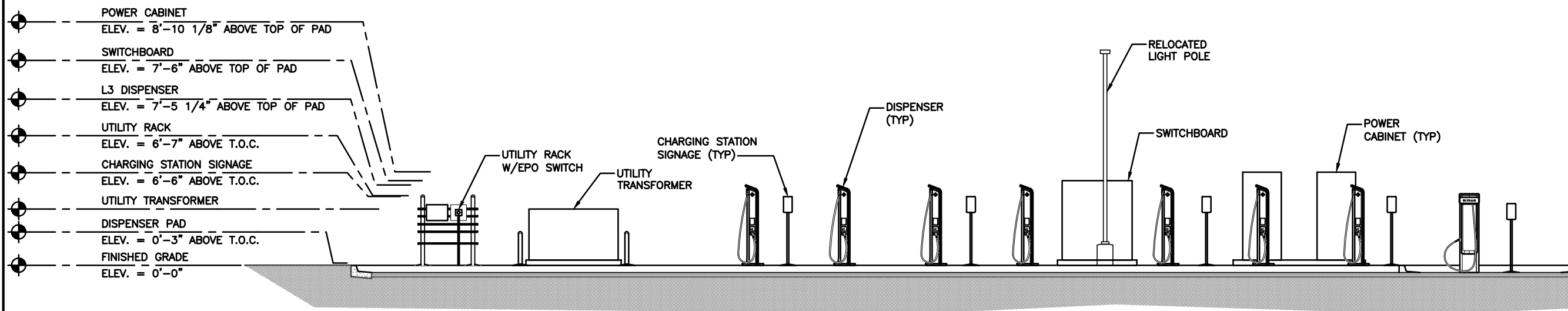

EQUIPMENT ELEVATION

STAMP: 2/24/2026

DocuSign by: *Chris Giannotti*

ENGINEERING LICENSE:
STATE OF WASHINGTON
STATE CERTIFICATE OF AUTHORIZATION # 602220502

ENGINEER:	PE#:	DISCIPLINE:
CG CHRISTOPHER GIANNOTTI 23038356	23038356	CIVIL
PMS PHILIP M. SWOBODA 25027516	25027516	CIVIL
SDK SHELTON D. KEISLING 24005575	24005575	ELECTRICAL
TMS TERRANCE M. SUPER 39005	39005	ELECTRICAL

PLANS PREPARED FOR:

PLANS PREPARED BY:

DRAWING NOTICE:
THIS DRAWING HAS NOT BEEN PUBLISHED AND IS THE SOLE PROPERTY OF SSC, INC. AND IS LENT TO THE BORROWER FOR THEIR CONFIDENTIAL USE ONLY, AND IN CONSIDERATION OF THE LOAN OF THIS DRAWING, THE BORROWER PROMISES AND AGREES TO RETURN IT UPON REQUEST AND AGREES THAT IT WILL NOT BE REPRODUCED, COPIED, LENT OR OTHERWISE DISPOSED OF DIRECTLY OR INDIRECTLY, NOR USED FOR ANY PURPOSE OTHER THAN FOR WHICH IT IS FURNISHED.

SUBMITTALS:

DESCRIPTION	DATE	BY	REV
ISSUED FOR PERMITTING	02/24/26	ITM	0

APPLICANT SITE NAME:
MARYSVILLE, WA

SSC SITE NUMBER:
RIVN-RAN-WA-0004

SITE ADDRESS:
2437 172ND ST NE, STE. EV
MARYSVILLE, WA 98271

SHEET DESCRIPTION: SITE ELEVATION	SHEET #: C-1.3
--------------------------------------	-------------------